

Q15P Inflator Operation Manual

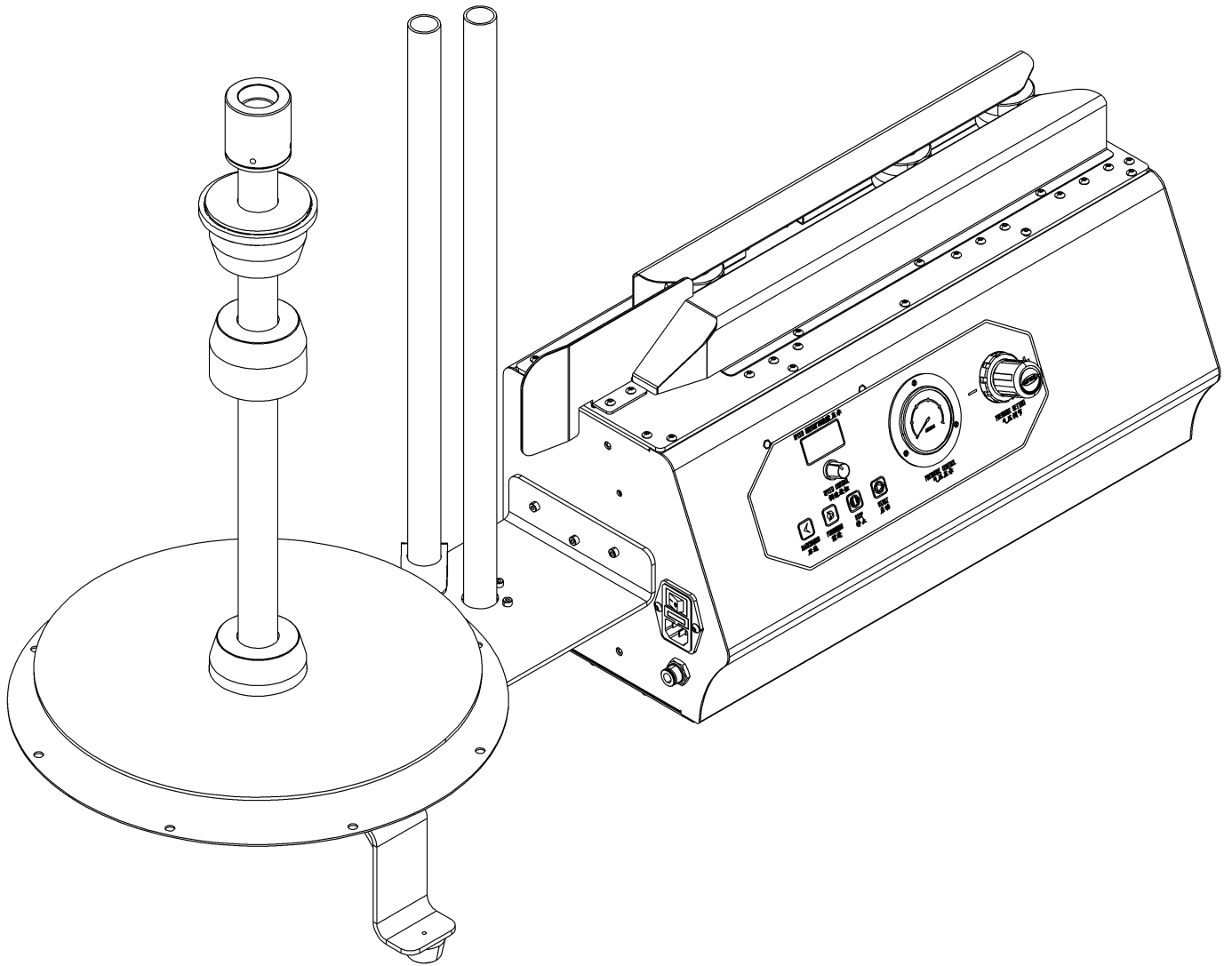

Before installing and using the product, please carefully read the user manual and keep it properly for future use

1.0 About this Operation Manual

The purpose of writing this manual is to guide operators in understanding the positions of various components of the inflator, and to learn system operation and basic troubleshooting.

The content of this manual is applicable to the Q15P inflator.

2.0 Safety Instructions for Use

2.1 Important safety instructions

1. Carefully read and fully understand all the contents of this manual.
2. Before officially starting the operating system, please confirm the following items

- Authorized distributors or technical personnel have provided systematic training to operators.
- The operator has read and understood all safety signs posted on the equipment.
- Confirm that the power supply for the inflator meets the requirements of the machine and has a reliable grounding device. (Please refer to Section 3.6: Power Requirements)

 Warning: Improper grounding may cause electric shock.

 Warning: Do not disassemble the machine's chassis. Only authorized technical personnel or trained and qualified full-time maintenance personnel can disassemble the chassis of the machine.

 Warning: Beware of getting caught in the machine. Do not place fingers, hair, jewelry, clothing, etc. near the traction wheels on the machine when pulling or inflating the air column coil.

3. Inflatable bags can only be used as packaging.

4. Before maintaining and repairing the equipment, please confirm that the power switch of the machine has been turned off and the power plug has been disconnected.

 Warning: Except for the operation instructions related to "maintenance and repair" in this manual, it is prohibited to repair or modify the Q15P inflator on your own. All maintenance work should be carried out by our company's representatives, authorized dealers, or trained and qualified professional maintenance personnel. If equipment damage is caused by failure to repair as required, our company will not be held responsible.

 Warning: Except for the replacement of blades and traction wheels specified in this manual, do not open the safety chassis of the machine.

5.Regularly inspect equipment to ensure:

- The power cord is undamaged and the copper core is not exposed:
- No debris residue on the traction wheel:
- All control and display components can operate normally.

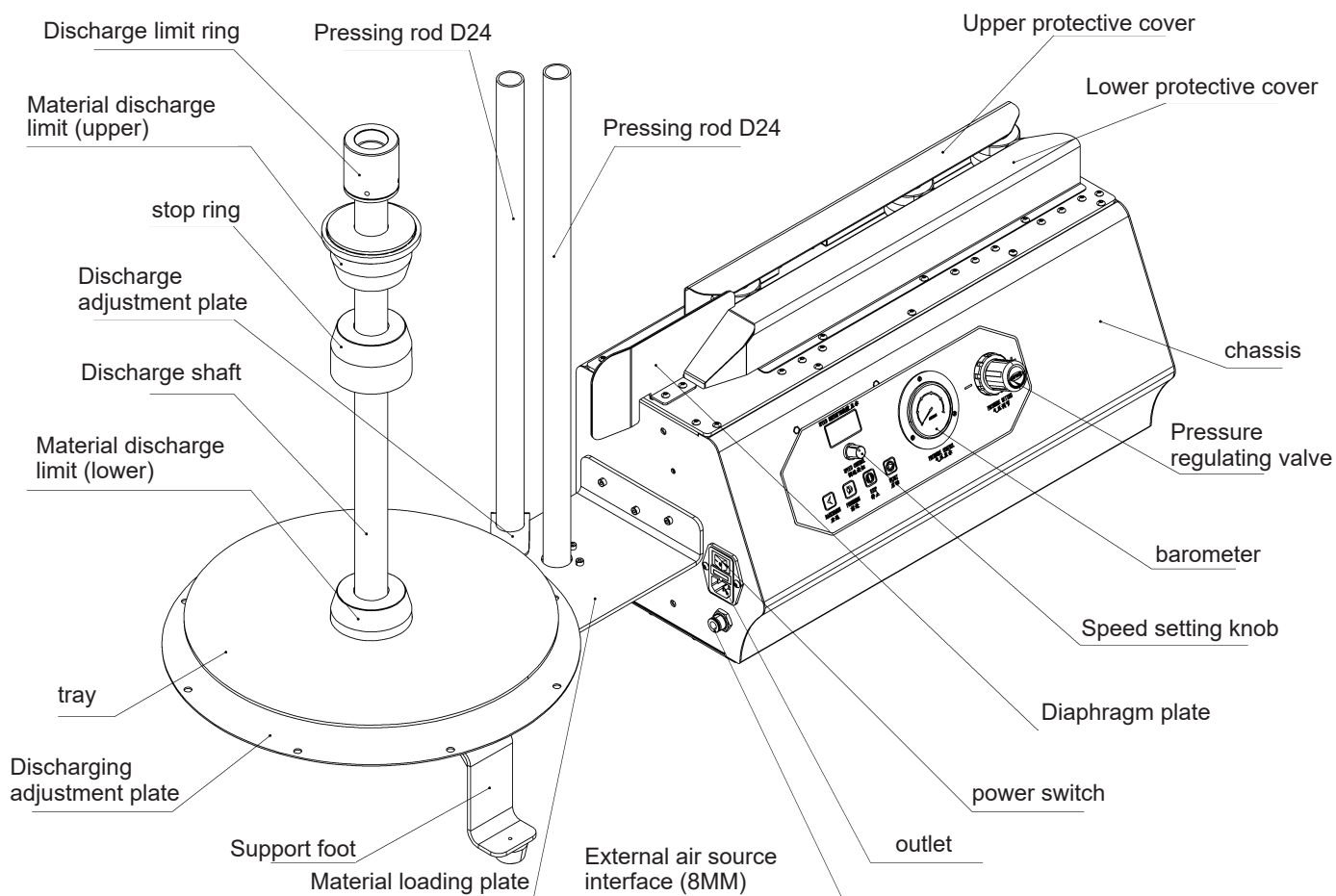

Figure 1 (Full view of the machine)

⚠ Warning: If any abnormalities are found during use that do not match the description in this operating manual, please immediately turn off the power switch, unplug the power plug, and contact our technical service representative.

6.ambient condition

- Storage temperature: machine 0-43 °C ; Air column coil: 0-43 °C .
- Operating temperature: machine 16-43 °C ; Air column coil: 16-43 °C .

7.Potential risks

Most of the components of the Q15P inflator are equipped with protective cases, but there are still a small number of components exposed, so caution is still required during operation.

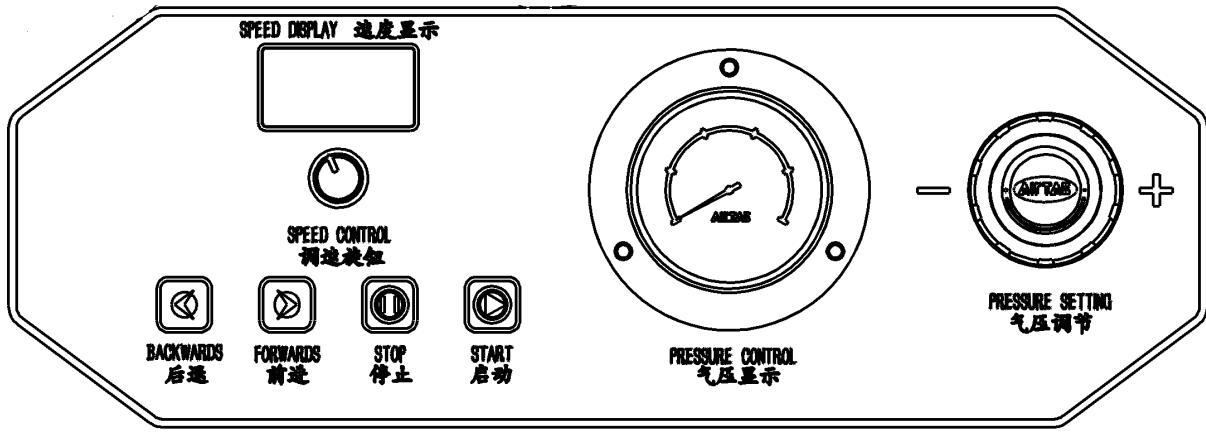

Figure 2 (Machine Operation Panel)

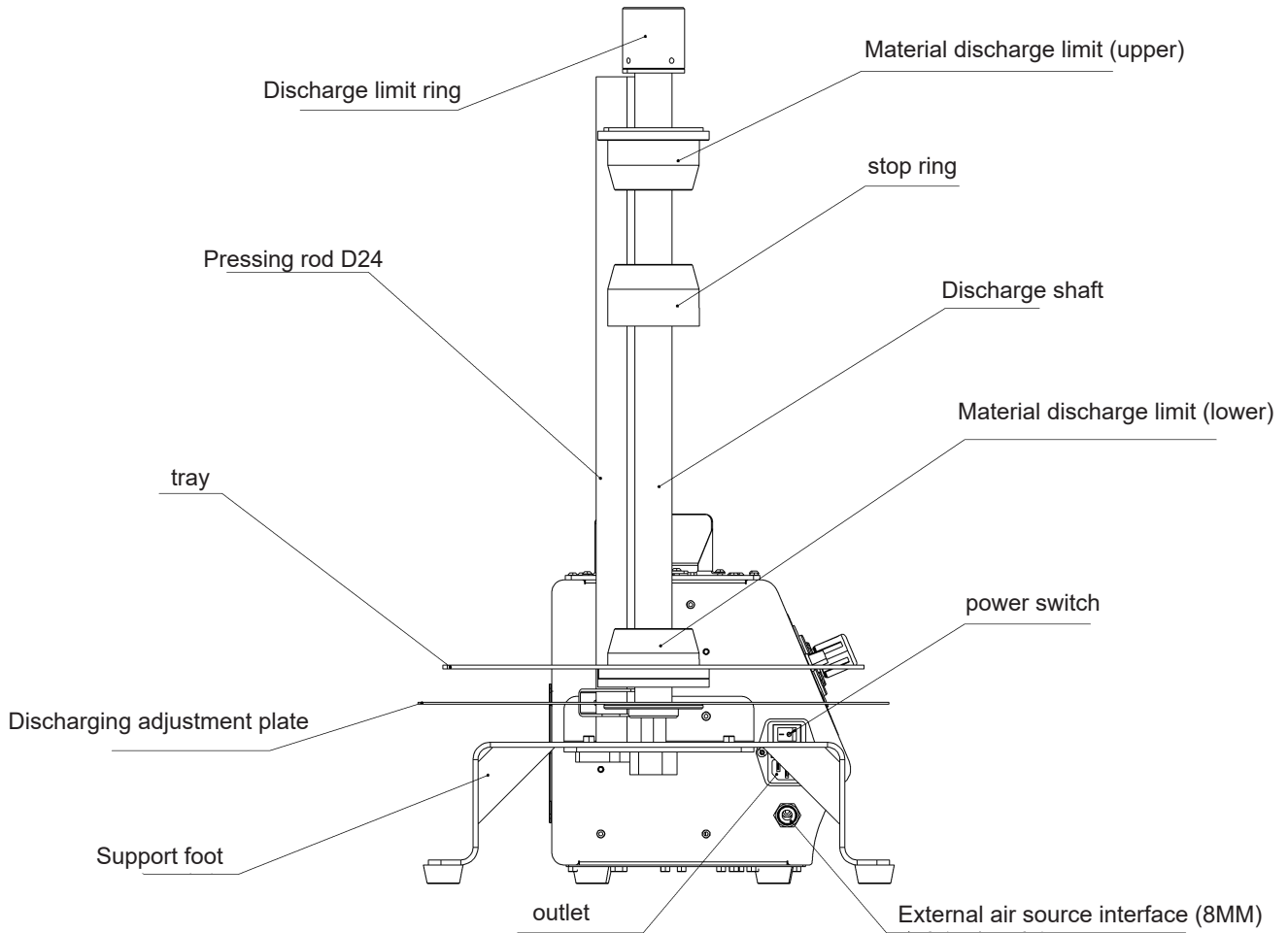

Figure 3 (Rear View of Machine)

3.0 Product Introduction

3.1 System Introduction

Q15P is a brand new compact and lightweight automatic air column inflator. The emergence of automatic air column inflators greatly saves labor costs and effectively avoids the situation of bag breakage caused by traditional manual inflation due to unstable air pressure, excessive air volume, and other reasons, successfully reducing the product damage rate. Q15P has fast speed, stable air pressure, and much higher efficiency than manual inflation. Can be filled with 15-100CM coiled material air column bags, U-shaped bags, L-shaped bags. (Note: An external air compressor is required)

1. Basic parameters

Inflator size:

760MM * 340MM * 610MM (L * W * H)

Net weight: 22.8KG

Inflator packaging size:

790MM * 400MM * 380MM(L * W * H)

Gross weight: 25KG

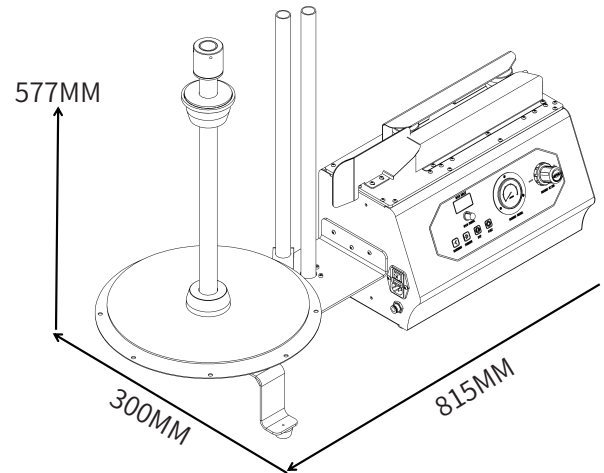

2. Technical Parameter

Product model: Q15P

Power connection method: Y

Speed: 15 meters/minute MAX

Anti electric shock category: Class I

Input voltage: Factory default AC 220V (110V adjustable)

Rated power: 320W

Capacity: adjustable in size

Rated frequency: 50HZ/60HZ

3.2 mode

● Conventional usage

Press the start button to start running, and then press the stop button to stop running.

● Usage of the supporting winding rack

If equipped with our company's matching winding rack, continuous and automatic winding operation can be achieved.

3.3 Operation method

1. After installing the discharge shaft, pressure rod, membrane plate, and discharge tray according to the position shown in Figure 1 (auxiliary work: hexagonal), connect the discharge load-bearing plate to the host, and connect the air compressor air pipe to the external air source interface;

2. Install the membrane vertically on the discharge shaft;

3. Connect the power cord to turn on the power supply. The membrane bypasses the pressure bar, passes through the air outlet pipe, and is pulled into the traction wheel. Press the forward button, wait for the membrane to be pulled outside the machine, and then press the start button to start inflation.

4. Adjust the air volume according to different specifications of air column coils, there is no fixed criterion, and self adjustment records are required

5. Machine winding method diagram

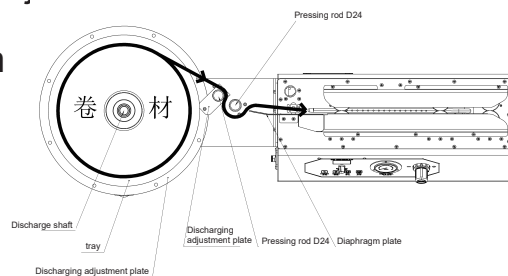

3.4 Fault code diagnosis and handling

1.E01:Material shortage alarm.

Solution: (1) Check if materials are stuck or consumables are used up. After confirmation, reload and clear the alarm to restart;

(2) The coding wheel spring piece is deformed, so that the coding wheel cannot detect the material. Use hand or Needle-nose pliers to adjust:

(3) The encoder wheel photoelectric switch does not light up or is constantly on. Please contact an authorized dealer or technical personnel for further processing.

2.E02:standby.

3.E03: Motor overcurrent alarm

Solution: (1) Check if materials or foreign objects are trapped in the silicone wheel or transmission shaft, and clean the silicone wheel and transmission shaft;

(2) Check if the resistance of the material is too high, exceeding the range of equipment use.

If you need further assistance, please contact an authorized dealer or technical personnel for further processing.

3.5 Precautions

1. The air column machine needs an external air source, and the air source pressure must be greater than the air pressure value adjusted on the Barometer of the air column machine. If it is found that the air column is still not full after continuously increasing the air pressure, check whether the pressure of the external air source is sufficient, and the external air source is generally about 5kgf/cm².

2. If it is found that one column of the air column bag is occasionally not fully blown or cannot be blown up, please contact the air column bag material supplier to check the bag inlet valve.

3.6 Electricity requirements

⚠ Warning: Improper grounding may cause electric shock.

⚠ Warning: Using a wiring board can increase static electricity, and electrostatic discharge can cause operational problems and discomfort for the operator. The Shenyuan demand voltage for the Q15P inflator is 220V, with a grain rate of 50H, a rated power of 320W, and a rated current of 2A. The machine has an internal grounding wire. Please use a single-phase three wire power cord. The power grid of the user must have a reliable grounding device, otherwise static electricity cannot be discharged, and the human body will become a conductor for static electricity discharge, resulting in discomfort caused by electric shock.

3.7 system composition

1.Main electrical switch

This switch is located on the back of the machine and is used to turn the system on and off.

2.Start/stop button

Used to control the machine to start or stop running.

3.Main power cord

Insert the power cord into the corresponding power outlet, see Section 3.6 "Power Requirements"

4.control panel

Button panel: used to operate and set machine related values.

5.Machine cover

Inside the cover of this machine are the electrical and mechanical components of the machine.

Warning: Do not open the machine cover. Only our company's technical personnel and authorized maintenance personnel can open it.

6.emptying device

The discharge device consists of a discharge support seat, a discharge shaft, and a discharge limit sleeve, used to place the air column coil and achieve fixed support for the air column coil. Rotate the air column coil and feed it to the machine for inflation operation.

7.Air column coil

Air column coil material with pre made air valve and air passage, which can be inflated through Q15P inflator and used for product packaging

4.0 Maintenance and repair

4.1 Preventive Maintenance

⚠ Warning: When maintaining and repairing the Q15P inflator, be sure to shut down the machine first and unplug the main power cord from the socket.

service interval	content	describe
weekly	Check cleanliness	1. Open the machine belt cover and blow away any dust and debris inside; 2. Check the machine components for abnormal wear and tear;
monthly	contact	1. Arrange an on-site inspection; 2. Contact an authorized dealer or our company's technical service representative to inspect the equipment

4.2 Replacing the blade

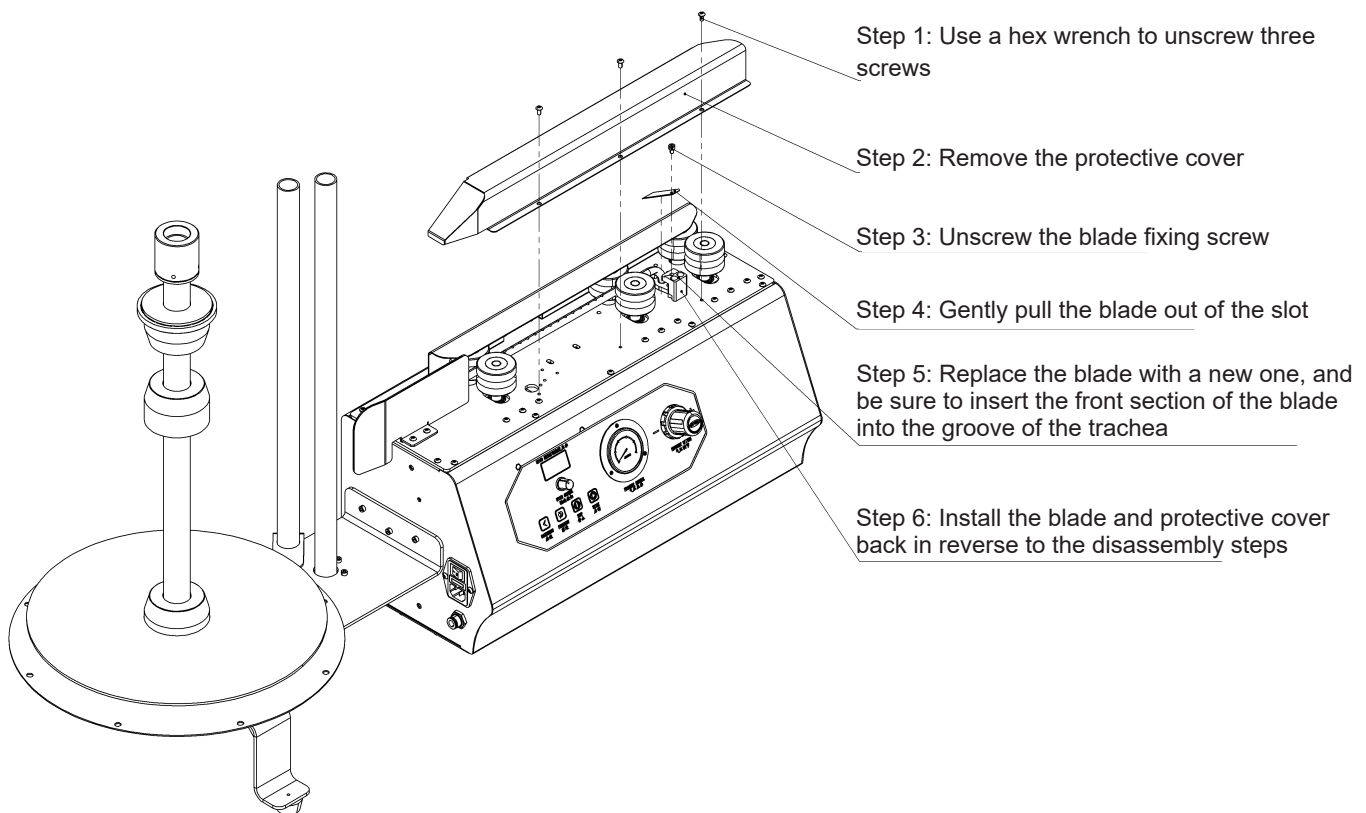

Figure 4 (Blade Removal and Installation Diagram 1)

Attention: The blade must be correctly placed in the blade groove; Blade and gasket positions are not interchangeable

Attention: The traction wheel and blade are vulnerable parts, please pay attention to replacement. Please contact an authorized dealer for purchase.

5.0 Maintenance and repair

warranty card		Warranty Regulations
Model:	Q15P	<p>Dear customer</p> <p>Thank you for purchasing our company's products. Thank you very much! In order to protect your legitimate rights and interests, relieve your worries, and improve after-sales service to customers, this warranty regulation is formulated. Please carefully read and provide valuable opinions and suggestions.</p> <p>1、 Our company's products enjoy a free warranty service of 12 months from the date of sale. If the warranty period exceeds 12 months from the date of sale, our company will charge the cost of parts at its discretion based on the malfunction of the product.</p> <p>2、 Please pack and transport the repaired products properly. Our company is not responsible for any damage or loss during transportation.</p> <p>3、 During the free warranty period, if the following events occur, our company has the right to refuse service or charge materials and service fees at its discretion.</p> <p>1. Improper use by users resulting in product malfunction or damage;</p> <p>2. Accidents caused by electric shock or improper installation leading to burning;</p> <p>3. Damage caused by disassembly and repair by non maintenance service providers;</p> <p>4. Damaged product labels;</p> <p>4、 Please read the product manual carefully before installing and using our company's products.</p> <p>5、 The warranty card must be stamped and dated by the selling unit to ensure your rights and interests.</p> <p>6、 Blades, gears, rubber wheels, and gas pipes are consumables and are not covered by the warranty.</p>
Sold Date:		
Sold units: <small>(Please affix official seal)</small>		
<p>*This certificate can only take effect after being stamped by the company</p>		

<p>产品合格 证明书 Inspection Certificate of conformity</p>	
<p>产品名称: <u>充气机</u> name <u>inflator</u></p>	<p>检验结果: <u>合格 Qualified</u> Result <u>合格 Qualified</u></p>
<p>产品型号: <u>Q15P</u> Model <u>Q15P</u></p>	<p>检验员: <u>检</u> Instpector <u>检</u></p>
	<p>检查日期: _____ Date _____</p>
<p>This product has passed the inspection and is allowed to leave the factory</p>	