

H06 Inflator Operation Manual

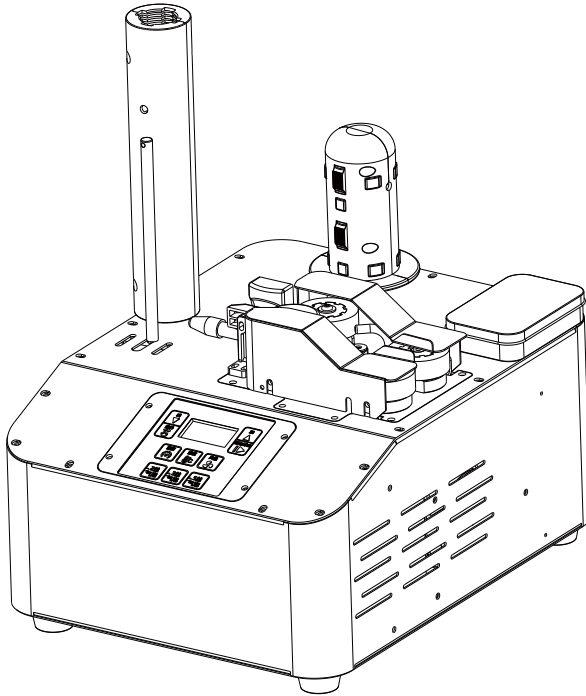

Before installing and using the product, please read the instruction manual carefully and keep it for future reference

1.0 About This Operation Manual

The purpose of this manual is to guide operators in identifying the parts of the inflator and to learn how to operate the system and troubleshoot basic faults.

The contents of this manual apply to the H06 Inflator.

2.0 Safety Instructions

1. Carefully read and fully understand all the contents of this manual.

2. Before officially starting the system, please ensure the following

- Authorized dealers or technical personnel have provided systematic training to operators.
- Operators have read and understood all the safety signs posted on the equipment.
- Ensure that the power supply providing power to the inflator meets the requirements of the machine and has a reliable grounding device.

 **Warning:** Improper grounding may lead to electric shock.

 **Warning:** Do not disassemble the machine's casing. Only authorized technical personnel or trained maintenance staff are allowed to open the machine's casing.

 **Warning:** Beware of being pulled into the machine. Do not bring fingers, hair, jewelry, clothing, etc., close to the traction wheels on the machine when it is pulling the air column roll material or inflating the air column roll material.

3. Inflatable bags should only be used for packaging purposes.

4. Before maintenance or repair, please ensure the power switch of the machine is turned off and the power plug is disconnected.

 **Warning:** Do not attempt to repair or modify the H06 Inflator yourself, except for the maintenance and repair operations specified in this manual. All repair work should be carried out by our representatives, authorized dealers, or professionally trained maintenance personnel. We are not responsible for any damage to the equipment caused by repairs not conducted in accordance with these requirements.

 **Warning:** Except for performing blade and traction wheel replacement operations specified in this manual, do not open the safety casing of the machine.

5. Regularly inspect the equipment to ensure:

- The power cord is undamaged, and the copper core is not exposed:
- There are no remnants of film debris on the traction wheels:
- All control and display components are functioning normally.

 **Warning:** If you notice any abnormalities with the machine during use, or if it exhibits behaviors not described in this operation manual, immediately turn off the power switch, disconnect the power plug, and contact our technical service representative.

6. Operating Conditions

Storage temperature: Machine 0-43°C; Air column roll material: 0-43°C. Operating temperature: Machine 16-43°C; Air column roll material: 16-43°C.

7. Potential Risks

Most parts of the H06 Inflator are covered with protective casings, but a few components are still exposed, so caution is advised during operation.

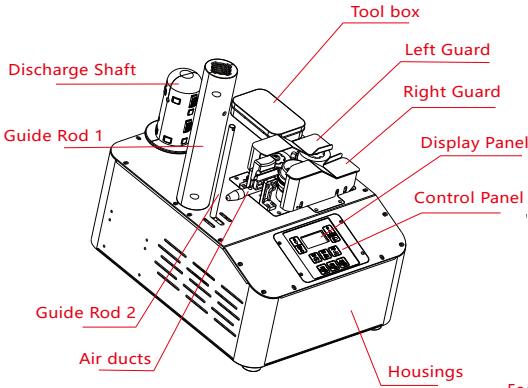

Figure 1 (Complete View of the Machine)

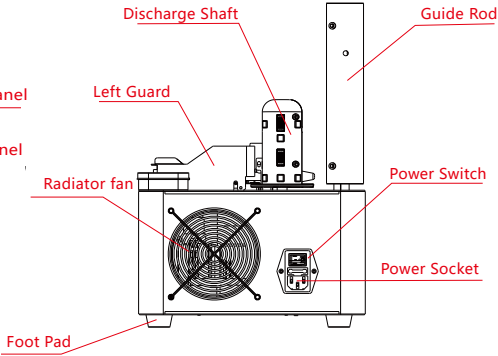

Figure 2 (Rear View of the Machine)

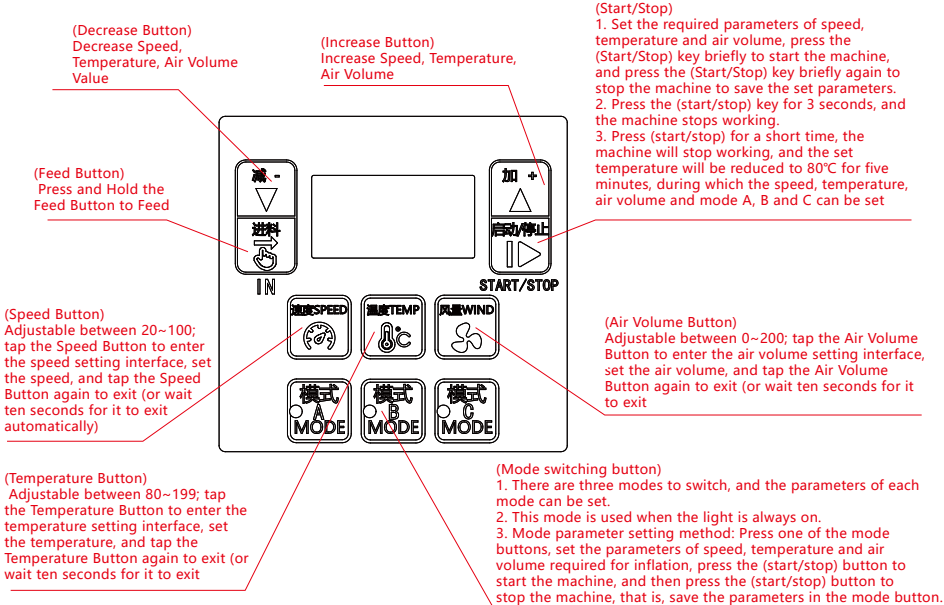

Figure 3 (Machine Control Panel)

3.0 Product Introduction

The H06 Inflator is an easy-to-use machine with a simple and clear operating interface. Its metal casing makes it sturdy, yet it is compact and lightweight, weighing less than 9KG. It is highly versatile, allowing temperature, air volume, and speed adjustments to accommodate different types of bags, with a maximum speed of 11 meters per minute. It offers great value for small factories, warehouses, and shops.

1. Basic parameters

Inflator size: 350MM * 270MM * 395MM (L * W * H)

Weight: 8.1KG

Inflator Packaging Dimensions:

415MM*325MM*285MM (Length*Width*Height) Net

Total Gross Weight of Packaging: 9.45KG

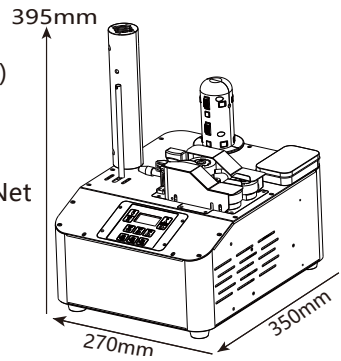

2. Technical Parameters

Model: H06

Speed: 11 meters/minute MAX

Gas volume: 700L/min Max.

Electric Shock Protection Type: Class I

Input Voltage: Factory default AC 110V/220V

Connection Type: Y

Rated Power: 450W

Rated Frequency: 50HZ/60HZ

3.2 Operating Method

After the power socket is connected to the power cord, turn on the power switch, then install the membrane in the discharge shaft, bypass the membrane between the material guide rod 1 and the material guide 2, directly penetrate the gas pipe head and pull it close to the roller, press and hold the feed button, and then press the start button to start inflation when the membrane is pulled out of the inflator. (Refer to Figure 4 (Machine Film Winding Diagram)).

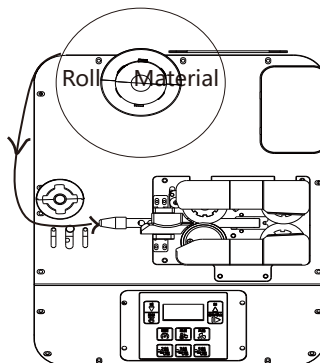

Figure 4 (Machine Film Threading Diagram)

3.3 Error Code Diagnosis and Troubleshooting

E01: Temperature sensor anomaly. A false alarm may occur during a cold start at low temperatures. Exit by pressing the pause button, then restart. If this alarm frequently occurs during operation or at relatively high ambient temperatures, it indicates that the temperature sensor has failed.

E02: Heating element overcurrent. First, check whether the heating wheel is damaged and whether the heating elements before and after the heating wheel are damaged. If damaged, please replace them.

E03: Heating element disconnected. First, check if the wires leading to the heating elements before and after the heating wheel are cut. If the wires are intact, check if the power supply wires connected to the heating element wires are cut. If all the above are normal, the control board needs to be replaced.

E04: Motor overcurrent. This code indicates that the motor has been overloaded or the transmission part is jammed. If all the above are normal, the motor needs to be replaced.

3.4 Precautions

1. Do not use in damp environments.

2. Before operation, please note the following:

- If the ground wire is not properly grounded, it may cause electric shock.

- Do not open protective or maintenance covers. Only authorized manufacturers or authorized dealer maintenance personnel are allowed to do so.

- Avoid contact between fingers, hair, clothing, and jewelry with the rollers during operation or loading of materials to prevent entanglement.

3. Inflatable bags are only for use as packaging materials. Do not use as flotation devices, pillows, children's toys, etc.

4. Do not load the inflator with materials exceeding 7KG, and the diameter of the film material should not exceed 22CM. Do not overload or lean on the material when loading.

5. Static electricity can be generated when materials are driven by the machine, and materials themselves may also carry static electricity. Operators should not wear slippers or be barefoot, as the human body can become a conductor for static discharge, leading to discomfort from electric shocks.

6. With long-term use of the machine, if the film cannot run smoothly or gets stuck, please replace the blade promptly.

7. During prolonged use, if the edges are not sealed firmly or the seal breaks, check if the temperature is correct and whether the rollers are damaged. If damaged, replace them promptly.

8. The speed and air volume of the inflator need to be adjusted in coordination. Different types of film require different parameter values, with no fixed standard values. Adjustments and records should be made accordingly.

Forbidden: The equipment must not run without material!!!

3.5 Electrical Requirements

 Warning: Improper grounding may result in electric shock.

 Warning: Using a power strip can increase static electricity, which may cause operational problems and discomfort for the operator. The H06 Inflator requires a power supply voltage of 110V/220V, frequency of 50Hz/60Hz, rated power of 450W, and rated current of 8A. The machine is internally grounded, so please use a single-phase three-wire power cord. The power network must have a reliable grounding device; otherwise, static electricity cannot be discharged, making the human body a conductor for static discharge and potentially causing discomfort from electric shocks.

3.6 Precautions

Warning: Using film not supplied by our company can cause poor bag making and may damage the machine, as well as affect the protective effect of the inflatable bags.

The storage temperature range for the film is 0-43°C. The film should be stored within this temperature range. Storing the film outside this temperature range may result in the film being scrapped.

The operating temperature range for the film is 16-43°C. The film should be used within this temperature range to achieve the best sealing effect.

3.7 System Components

1. Main Power Switch: This switch is located on the back of the machine, used to turn the system ON or OFF.
2. Main Power Cord: Insert the power cord into the corresponding power outlet.
3. Radiator fan:Used to control the inside of the machine, so as to ensure the normal operation of the machine.
4. Control Panel: Used for operating and setting machine-related values. The display screen allows for visual operation and understanding of machine parameters.
5. Guide Rod :Used to assist the discharging shaft to discharge and smooth the film material.
6. Discharge Shaft: Used to mount the film roll, providing fixed support for the film roll to rotate and feed into the machine for inflation and sealing operations.
7. Left and right shields:Used to protect the trachea, blades and heating modules.

 Warning: The heating module is hot; be careful to avoid burns.

 Warning: Beware of being pulled into the machine.

4.0 Maintenance and Repair

4.1 Preventive Maintenance

 Warning: When maintaining and repairing the H06 Inflator, make sure to turn off the machine and unplug the main power cord from the socket.

Maintenance cycle	Content	Description
Weekly	Cleaning Inspection	1.Open the machine's left and right protective covers, blow off the dust and debris inside; use a cotton cloth dipped in alcohol to wipe and clean the surface of the heating wheel. 2.Check for wear on machine parts, and replace components promptly if worn;
Monthly	Contact	1.Arrange a site inspection; 2.Contact authorized dealers or our company's technical service representatives to inspect the equipment

4.2 Blade Replacement

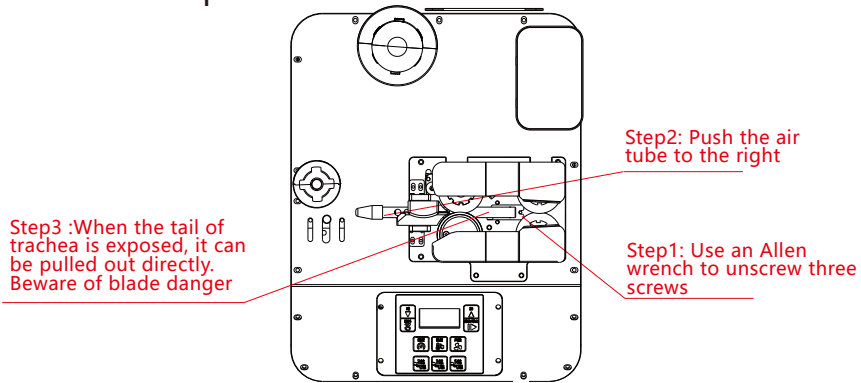

Figure 5 (Diagram of Air Tube and Blade Disassembly and Installation)

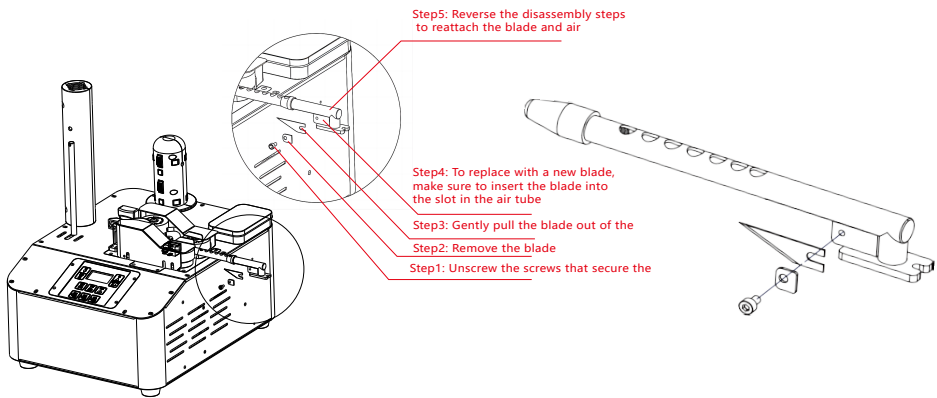

Figure 6 (Diagram of Air Tube and Blade Disassembly and Installation)

Note: The blade must be correctly placed in the blade slot; the position of the blade and the spacer cannot be interchanged

Note: The traction wheel and blade are wear-and-tear items, please pay attention to replacement. For purchases, contact an authorized dealer.

Midel: H06			Parts List		
Name	Unit	Quantity	Name	Unit	Quantity
Ceramic Blade	Piece	3	Instruction Manual	Copy	1
2.5MM Allen Wrench	Piece	1	Power Cord	Piece	1
3MM Allen Wrench	Piece	1	Discharge Shaft	Piece	1
Guide Rod1	Piece	1	Guide Rod2	Piece	1
Note					

5.0 Warranty Card and Certificate of Conformity

Warranty Card		Warranty Terms
Product Model:	H06	<p>Dear Customer, Thank you for purchasing our product. To protect your legal rights and relieve any concerns you may have, as well as to improve our customer service, we have established these warranty terms. Please read them carefully and provide your valuable feedback and suggestions.</p> <p>I. Our company's products come with a 12-month free warranty service from the date of sale. If the product exceeds the 12-month warranty period from the date of sale, our company will charge for parts cost depending on the fault condition.</p> <p>II. Please ensure that the product sent for repair is properly packaged and transported. Our company is not responsible for any damage or loss during transportation.</p> <p>III. During the free warranty period, if the following situations occur, our company reserves the right to refuse service or charge a discretionary fee for materials and services.</p> <ol style="list-style-type: none"> 1. Faults or damages caused by improper use by the user; 2. Accidents caused by electrical shock or improper installation resulting in damage; 3. Damage caused by unauthorized repair attempts; 4. Damaged product labels; <p>IV. Please read the product manual carefully before installing and using our company's products.</p> <p>V. The warranty card must be stamped and dated by the seller to ensure your rights.</p> <p>VI. Blades, gears, rubber wheels, and air tubes are considered wear items and are not covered by the warranty.</p>
Date of Sale:		
Selling Unit: (Please stamp)		
<p>This certificate becomes effective only after being stamped by the company</p>		

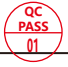
Product Conformity Certificate	
Name: _____ Inflator _____	Inspection :  _____ Result _____
Model: _____ H06 _____	Inspector:  _____
Date: _____	
<p>This product has been inspected and is allowed to leave the factory as qualified</p>	